

GTS18SBS

GE® 17.9 Cu. Ft. Stainless Top-Freezer Refrigerator

Dimensions and Installation Information (in inches)

Overall Dimensions	Height to top of hinge (in.) A	66-5/8
	Height to top of case (in.) B	66-1/8*
	Case depth without door (in.) C	27-1/2
	Case depth less door handle (in.) D	30-1/4
	Case depth with door handle (in.) E	32-1/8
	Depth with fresh food door open 90° (in.) F	58-1/8
	Width (in.) G	29-1/2
	Width with door open 90° inc. door handle (in.) H	32
Air Clearances	Each side (in.)	1/8
	Top (in.)	1
	Back (in.)	1

*Height to mid-freezer (in.): 53-15/16

Front View

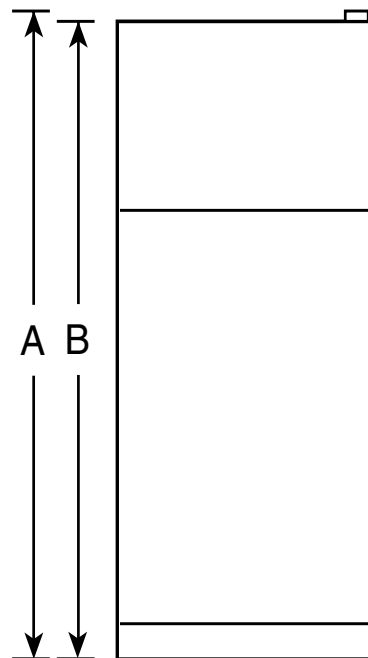

Top View

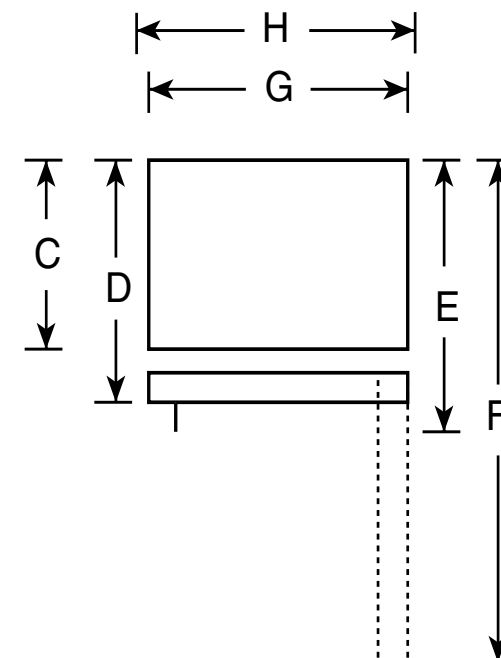

For answers to your Monogram®, GE Profile™ or GE® appliance questions, visit our website at ge.com or call GE Answer Center® service, 800.626.2000.



Specification Revised 4/06

310391

GTS18SBS

GE® 17.9 Cu. Ft. Stainless Top-Freezer Refrigerator

Features and Benefits

- Stainless Steel - Convey a look of utmost polish and sophistication
- Illuminated Upfront Slimline Temperature Controls - Offer maximum style and convenience
- Adjustable Spillproof Glass Shelves - Help contain spills for ease of cleaning
- Adjustable Humidity Vegetable/Fruit Crispers - Provide the ideal storage environment for fruits and vegetables
- Adjustable Gallon Door Bins - Make room for milk and other gallon-size containers
- Spillproof Freezer Floor - Seamless design offers easy cleanup
- NeverClean™ Condenser - Condenser coils are encased, so they don't require cleaning in normal operating environments
- Deluxe Quiet Design - Significantly reduces operating noise
- Model GTS18SBSSS - Stainless steel

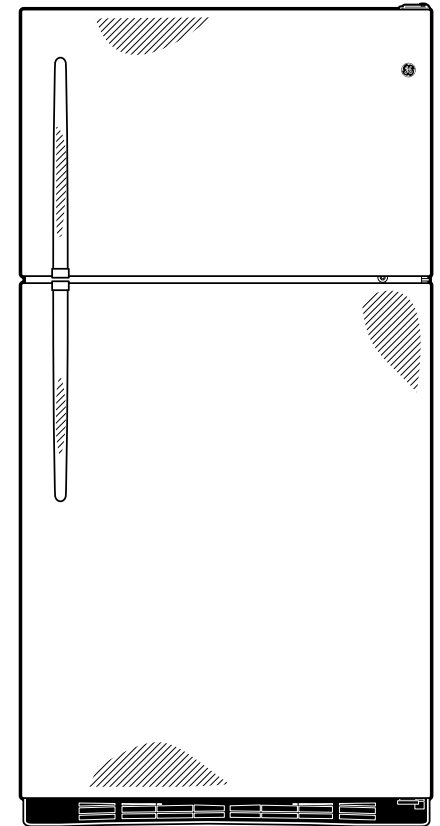

imagination at work

Specification Revised 4/06

310391